

4-Axis Load Cell

Controls Overhead Crane

Product HiLites

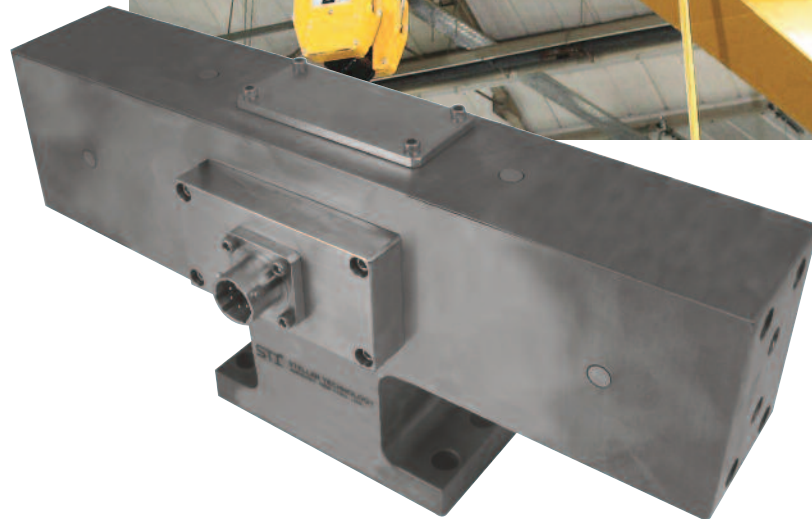

In this unique force measurement application, the challenge for Stellar Technology engineers was to create a 250 pound, 4-axis load cell with very high off-axis capability and minimal cross-talk. The load cell also had to fit into the user interface of a new material handling system. The solution was a modified Model CLC910 load cell producing 0.2% accuracy and 4 separate $\pm 10\text{Vdc}$ outputs. This unit is constructed from nickel plated steel and is shock and vibration protected to endure rugged use on the shop floor.

This load cell is actually an integral part of the interface between an operator and a mechanical lifting system. Fitted with handles for the operator to grasp, this load cell acts as a joystick, responding to the operator's hands as they push, pull, lift, or rotate the component being moved. Buttons located on the handles control the clamp/unclamp function as this system directs a servo-driven overhead gantry crane to move heavy components into the desired position.

LORD SENSING
Stellar Technology
237 Commerce Drive
Amherst, NY 14228 • USA
Tel: 716.250.1900
Fax: 716.250.1909
Web: stellartech.com
Email: info@stellartech.com

Copyright © 2015 LORD Corporation
All Rights Reserved

ISO 9001/AS9100

Your Application-Solution SourceSM