



ISO 9001/AS9100 Certified

# CTH932

PUMP OFF CONTROL POLISHED ROD LOAD CELL

YOUR ENGINEERED SOLUTION SOURCE <sup>SM</sup>



## DESCRIPTION

The Series CTH932 load cells are designed specifically for the polished rod of an oilfield pump off control system. Each of these load cells is designed to meet the rigorous performance standards required in the harsh environment of an oilfield production site.

These 0.50% accuracy load cells are constructed of all welded stainless steel, are hermetically sealed, and have a robust cable strain relief. Each load cell has shock and vibration protection construction as standard. Electrical output is 2 mV/V. Standard full scale capacity ranges are 30,000 lbf. and 50,000 lbf. Customer specific configurations can also be designed. This load cell contains no active electronics.

## STANDARD FEATURES

- Full Scale Capacities to 50,000 lbf
- 0.50% FSO BFSL Accuracy
- Welded Stainless Steel
- 2 mV/V Output
- Shock and Vibration Rated
- Operating Temperature of -40°F to 180°F
- NIST Traceable
- Fatigue Life of 50,000,000 Cycles
- 200% Overload without Damage
- Cable Hook Included

## OPTIONAL FEATURES

- Installation Kit (spherical washer loading set)

## PERFORMANCE

### STANDARD RANGES

30,000 lbf. and 50,000 lbf.

### FULL SCALE OUTPUT

2mV/V  $\pm 1\%$  FS.

### ACCURACY

0.50% FS BFSL.

### ZERO BALANCE

0  $\pm 1\%$  FS.

## ENVIRONMENTAL CHARACTERISTICS

### OPERATING TEMPERATURE RANGE

-40°F to 180°F.

### COMPENSATED TEMPERATURE RANGE

0°F to 150°F.

### TEMPERATURE EFFECT ON ZERO

-40°F to 180°F.

### TEMPERATURE EFFECT ON SPAN

0.005% Reading/°F.



A US Manufacturer of: Pressure, Temperature, Load/  
Force/Torque, and Displacement Sensors.

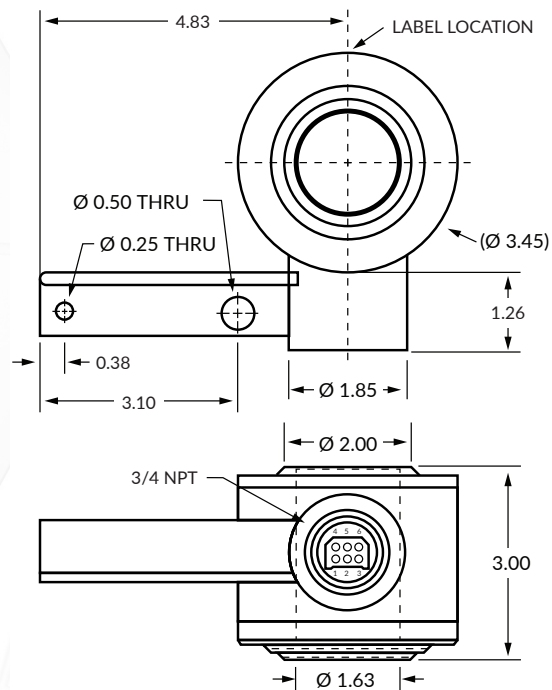

## MECHANICAL CHARACTERISTICS

### CALIBRATION

5 Points (0, 50%, 100%, 50%, 0 Range)  
Compression.

### STATIC OVERLOAD CAPACITY

200% Range.

### CONSTRUCTION

Hermetic Welded Stainless Steel.

### CONNECTOR

Stainless Steel shell with hermetic  
glassed in gold plated pins.

## ELECTRICAL CHARACTERISTICS

### BRIDGE RESISTANCE

2000 Ohms nominal.

### TYPICAL EXCITATION

5 to 15 Vdc or Vac.

### CONNECTOR PINS

1	+ EXE
3	+ SIG
4	- EXE
6	- SIG
5	GROUND

### MODIFICATIONS AND WARRANTY

MODIFICATIONS: We realize transducer applications vary greatly and as such our designs are flexible. Choice of pressure port, electrical termination, material compatibility and performance characteristics are a few of the many options available. Specifications on this datasheet represent the standard configuration only. Product and company names listed are trademarks of their respective companies. Specifications subject to change without notice.  
WARRANTY: Stellar Technology warrants that its product shall be free from defective workmanship and/or material for a twelve month period from the date of shipment, provided that Stellar Technology's obligation hereunder shall be limited to correcting any defective material FOB our factory. No allowance will be made for any expenses incurred for correcting any defective workmanship and/or material without written consent by Stellar Technology. This warranty is in lieu of all other warranties expressed or implied.



ISO 9001/AS9100  
237 Commerce Drive • Amherst, NY 14228 • USA  
Tel: 716.250.1900 • Fax: 716.250.1909  
Web: stellartech.com • Email: info@stellartech.com

Due to the nature of technology, changes are inevitable. For latest technical specifications, see our website.

